

**SANGAMON COUNTY
ORDINANCE NO. 9-1**

**AN ORDINANCE AMENDING RESOLUTION NO. 16-1, A RESOLUTION
ESTABLISHING AND AMENDING THE BOUNDARIES OF AN ENTERPRISE ZONE
WITHIN THE CITY OF LINCOLN AND COUNTY OF LOGAN, ILLINOIS TO ADD
TERRITORY IN THE COUNTY OF SANGAMON, ILLINOIS AND THE VILLAGE OF
ELKHART, ILLINOIS (AND ALL AMENDATORY ORDINANCES AND
RESOLUTIONS THERETO)**

WHEREAS, Sangamon County adopted Resolution No. 16-1 on September 14, 2004 (“Resolution No. 16-1”) amending the “Lincoln/Logan County Enterprise Zone” by adding Sangamon County and the Village of Elkhart, and various contiguous territories within such County and Village, to such enterprise zone (the “Enterprise Zone”), all pursuant to the Illinois Enterprise Zone Act (the “Act”), Chapter 20, Sec. 655/1 et. seq., Ill. Compiled Statutes, (20 ILCS 655/1 et. seq.). The Enterprise Zone was originally certified as an “enterprise zone” by the State of Illinois when the City of Lincoln and Logan were the only participants, and the state thereafter re-certified the “enterprise zone” when Sangamon County and the Village of Elkhart were added as participants;

WHEREAS, Sangamon County has subsequently adopted amendatory resolutions and ordinances relative to the Enterprise Zone (Resolution No. 16-1 and all other resolutions and ordinances of Sangamon County regarding the Enterprise Zone, being herein collectively referred to as, the “Enterprise Zone Ordinance”);

WHEREAS, on December 16, 1986 and on February 17, 1987, respectively, Logan County and the City of Lincoln executed that certain Enterprise Zone Intergovernmental Agreement, as amended by that certain “Amendment to the 1986, 1987 Enterprise Zone Intergovernmental Agreement dated September 21, 2004” among the County of Logan, Illinois,

FILED

APR 23 2008

Joe Aiello
Sangamon County Clerk

the City of Lincoln, Illinois, the Village of Elkhart, Illinois and the County of Sangamon, Illinois (as further amended, the “Intergovernmental Agreement”);

WHEREAS, the Enterprise Zone now encompasses approximately 6.0883 square miles and the Act allows the zone to encompass up to 15 square miles;

WHEREAS, it has been determined that additional territory within the unincorporated areas of Logan County, Illinois all, contiguous to the existing Enterprise Zone and totaling up to 0.2240 square miles, would be benefited by being encompassed within the boundaries of said Enterprise Zone, and it would be in the best interests of the citizens of County of Sangamon, Illinois, Logan County, Illinois, the City of Lincoln, Illinois and the Village of Elkhart, Illinois that said additional territory be included in the Enterprise Zone;

WHEREAS, Sangamon County now agrees to enact certain amendments to the Enterprise Zone, including amendments to expand the territory included in the Enterprise Zone to include the property in unincorporated Logan County as described in the immediately preceding paragraph, to clarify that building materials to be incorporated into real estate located in the Enterprise Zone (regardless of the location of the purchase of such materials) will be entitled to all sales and use tax exemptions provided under the Illinois Retailers’ Occupation Tax Act, and to authorize the Zone Administrator of the Enterprise Zone to issue a Certificate of Eligibility for Sales Tax Exemption in order to claim a sales and use tax exemption on building materials for eligible projects;

WHEREAS, Rail Splitter Wind Farm LLC (“Rail Splitter”) plans to develop, potentially with one or more entities affiliated with Rail Splitter, an electric wind energy project in the additional territory to be included in the Enterprise Zone;

WHEREAS, Rail Splitter intends to pay ad valorem taxes imposed upon its real property located within the Enterprise Zone and does not intend to seek any abatement of such taxes on the basis that such real property is located within the Enterprise Zone; and

WHEREAS, a public hearing regarding such amendments has been held as provided by the Act.

NOW, THEREFORE BE IT ORDAINED BY THE COUNTY BOARD AS FOLLOWS:

SECTION ONE: That “Exhibit A” and “Exhibit B”, as amended, which are attached to the Enterprise Zone Ordinance and incorporated by reference to Section 2 of said Enterprise Zone Ordinance, shall be and the same is hereby amended to include and incorporate therein the property legally described on Exhibit A attached hereto and made a part hereof by reference (and which is further depicted in the map attached hereto as Exhibit B and which is made part hereof by this reference) (the “Amended Territory”); and that the Amended Territory is hereby designated part of the Enterprise Zone pursuant to and in accordance with the Act;

SECTION TWO: The Enterprise Zone Ordinance is hereby amended by adding the following provision thereto and by deleting in their entirety all current terms and provisions of the Enterprise Zone Ordinance which are contrary to the following terms and provisions (including, but not limited to, by deleting Section 6 of Resolution No. 16-1):

Each retailer who makes a sale of building materials to be incorporated into real estate within the enterprise zone known as the Lincoln/Logan County Enterprise Zone (as supplemented and amended) by remodeling, rehabilitation or new construction (each, a “Project”), may deduct receipts from such sales when calculating the tax imposed by the Illinois Retailers’ Occupation Tax, but only if the Zone Administrator has issued a Certificate of Eligibility for Sales Tax Exemption with respect to the Project (a copy of which is required to be provided to the applicable retailer at the time of the sale).

For the sake of clarity, the preceding amendment, among other matters, clarifies (i) that references to the sales and use tax exemption available under the Enterprise Zone should be to the "Illinois Retailers' Occupation Tax Act"; (ii) that an otherwise qualified sale of building materials need not occur within the Enterprise Zone boundary to be eligible for the aforementioned tax benefits; and (iii) that a purchaser seeking the aforementioned tax benefits need not obtain a building permit as a condition to being eligible for such tax benefits.

SECTION THREE: The Enterprise Zone Ordinance is hereby amended by adding the following provision thereto and by deleting in their entirety all current terms and provisions of the Enterprise Zone Ordinance which are contrary to the following terms and provisions:

The Zone Administrator is hereby authorized and directed to issue Certificates of Eligibility for Sales Tax Exemption pursuant to the Retailers' Occupation Tax Act (35 ILCS 120/5k) for qualifying Projects.

SECTION FOUR: That the Chairman of the Sangamon County Board shall have, and is hereby granted, the authority to execute that certain "Amendment to Enterprise Zone Intergovernmental Agreement Between Logan County, the City of Lincoln, Sangamon County and the Village of Elkhart", a copy of which is attached hereto as Exhibit C.

SECTION FIVE: That, except to the extent amended hereby, all provisions, agreements, stipulations, rights, obligations and duties set forth in the Enterprise Zone Ordinance, as previously amended shall remain in full force and effect. Any resolution, ordinance or parts of any resolution or ordinance in conflict herewith are hereby repealed. In confirmation and furtherance thereof, in the event of any conflict or inconsistency between the terms and provisions of this Ordinance and the Enterprise Zone Ordinance (without giving effect to this Amendment), the terms and provisions of this Ordinance shall govern and control and the conflicting and inconsistent terms and provisions of the Enterprise Zone Ordinance (without giving effect to this Amendment) shall no longer have any force or effect.

SECTION SIX: That this Ordinance shall be in full force and effect from and after its passage and approval and publication as required by law, and from and after its approval by the Illinois Department of Commerce and Economic Opportunity.

SECTION SEVEN: That this Ordinance, and every provision hereof, shall be considered separable, and the invalidity of any portion of this Ordinance shall not affect the validity of the remainder.

SECTION EIGHT: That the County Clerk is hereby directed and authorized to publish this Ordinance in pamphlet form as required by law and forward a certified copy of this Ordinance to the Illinois Department of Commerce and Economic Opportunity for its approval and to file a certified copy of this Ordinance with the City Clerk for the City of Lincoln, the Village Clerk for the Village of Elkhart and the County Clerk for Logan County.

SECTION NINE: That the Zone Administrator is hereby authorized and directed to cause an application to be submitted to the State of Illinois pursuant to the Act in relation to the amendments contained in this Ordinance.

Sangamon County Board Finance Committee
April 22, 2008

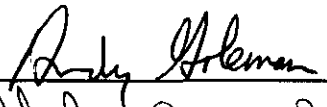

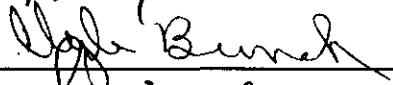



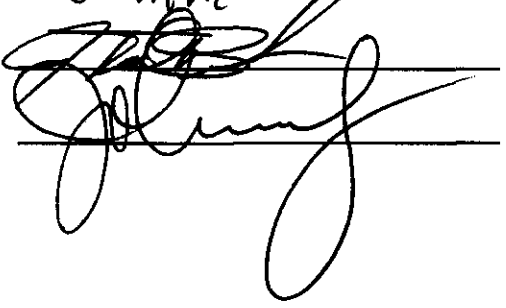

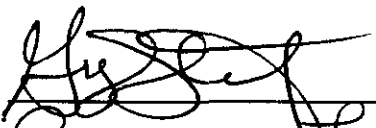

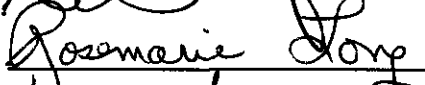

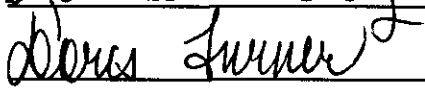

AYES 26 NAYS: 0 ABSENT: 2

PASSED AND APPROVED this 13th day of May, 2008.

A. V. [Signature]

SANGAMON COUNTY BOARD

Joe [Signature]

SANGAMON COUNTY CLERK

Published in pamphlet form by authority of the County Board, County of Sangamon, Illinois, the 13th day of May A.D., 2008.

Joe [Signature]

SANGAMON COUNTY CLERK

EXHIBIT A
Legal Description of the Amended Territory

Three Foot Strip of Land Connecting Existing Enterprise Zone (Lincoln, Logan County, Illinois) to Rail Splitter Wind Farm

A strip of land 3 feet wide in Townships 20 North, 21 North and 22 North, all in Range 3 West of the Third Principal Meridian, in Logan County, Illinois and lying 1.5 feet on each side of the following described Centerline:

Beginning at the intersection of the Centerline of Illinois Route 10 and the easterly Right-of-Way Line of Interstate 55; thence westerly along the Centerline of Illinois Route 10 to its intersection with the Centerline of Interstate 55; thence northerly along the Centerline of Interstate 55 through Sections 27 and 22, in Township 20 North, Range 3 West of the Third Principal Meridian, Logan County, Illinois to its intersection with the Centerline of Interstate 155; thence northerly along the Centerline of Interstate 155 through Sections 22, 15, 16, 10, 9, 8, 4 and 5, all in Township 20 North, Range 3 West of the Third Principal Meridian, Logan County, Illinois; thence northerly along the Centerline of Interstate 155 through Sections 32, 29, 20, 17, 8 and 5, all in Township 21 North, Range 3 West of the Third Principal Meridian, Logan County, Illinois to the South Line of Section 32, Township 22 North, Range 3 West of the Third Principal Meridian, Logan County, Illinois; thence easterly along the South Line of said Section 32 and along the South Line of Sections 33 and 34, all in Township 22 North, Range 3 West of the Third Principal Meridian to the Southeast Corner of the Southwest Quarter of said Section 34 and the Point of Terminus.

Three Foot Connector Strips for Enterprise Zone (Orvil Township, Logan County, Illinois) at Rail Splitter Wind Farm

A strip of land 3 feet wide lying 1.5 feet on each side of the following described Centerlines in Sections 34, 35 and 36, Township 22 North, and Sections 1, 2, 3, 10, 11 and 12, Township 21 North, all in Range 3 West of the Third Principal Meridian, in Logan County, Illinois, more particularly described as follows:

Centerline No. B-1

Beginning at the Southeast Corner of the Southwest Quarter of said Section 35, said point being on the Centerline of Stagecoach Road. From said Point of Beginning, thence northerly along the Centerline of said Stagecoach Road to a point 1.5 feet south of the North Line of said Section 35; thence easterly along a line 1.5 feet south of and parallel with the North Line of said Sections 35 and 36 to a point 1.5 feet west of the East Line of said Section 36; thence southerly along a line 1.5 feet west of and parallel with the East Line of said Section 36 to the North Line of the Southeast Quarter of said Section 36; thence westerly along the North Line of the Southeast Quarter and the Southwest Quarter of said Section 36 to the Northwest Corner of said Southwest Quarter; thence southerly along the West Line of said Southwest Quarter to the Southwest Corner thereof and the Point of Terminus.

Centerline No. B-2

Beginning at the Southwest Corner of the Northwest Quarter of said Section 36. From said Point of Beginning, thence northerly along the West Line of said Northwest Quarter to the Northwest Corner thereof and the Point of Terminus.

Centerline No. O-1

Beginning at the Southeast Corner of the Southwest Quarter of said Section 34. From said Point of Beginning, thence east along the South Line of said Sections 34, 35 and 36 to the Southeast Corner of said Section 36 and the Point of Terminus.

Centerline No. O-2

Beginning at the Northeast Corner of said Section 2. From said Point of Beginning, thence southerly along the East Line of said Section 2 to the Southeast Corner thereof; thence westerly along the South Line of said Sections 2 and 3 to the Southwest Corner of said Section 3 and the Point of Terminus.

Centerline O-3

Beginning at the Northwest Corner of the East Half of the East Half of said Section 1. From said Point of Beginning, thence southerly along the West Line of East Half of the East Half of said Section 1 to the Southwest Corner of the East Half of the East Half of said Section 1 and the Point of Terminus.

Three Foot Connector Strip for Enterprise Zone (Eminence Township, Logan County, Illinois) to Railsplitter Wind Farm

Centerline No. E-1

A strip of land 3 feet wide in Section 6 and 7, Township 21 North and Section 31, Township 22 North, all in Range 2 West of the Third Principal Meridian, in Logan County, Illinois, and lying 1.5 feet on each side of the following described Centerline:

Beginning at the Northwest Corner of the Northwest Quarter of said Section 6. From said Point of Beginning, thence east along the North Line of said Northwest Quarter to the Northeast Corner thereof; thence south along the East Line of said Northwest Quarter, the East Line of the Southwest Quarter of said Section 6 and the East Line of the Northwest Quarter of said Section 7 to a point 1800 feet south of the Southeast Corner of the Southwest Quarter of said Section 6 and the Point of Terminus.

Wind Turbine No. B-35-4-1

A strip of land 3 feet wide being a part of the Southeast Quarter of Section 35, Township 22 North, Range 3 West of the Third Principal Meridian, Logan County, Illinois and lying 1.5 feet on each side of the following described Centerline:

Commencing at the Northeast Corner of said Southeast Quarter, thence south 10.00 feet along the East Line of said Southeast Quarter to the Point of Beginning; From said Point of Beginning, thence south 88°-03'-10" west (Bearings derived from Global Positioning – Illinois State Plane Coordinates – West Zone) 2644.21 feet; thence south 01°-39'-03" east 529.56 feet; thence north 88°-12'-10" east 278.51 feet to the Point of Terminus.

ALSO:

All that part of a circle lying in the Southeast Quarter of Section 35, Township 22 North, Range 3 West of the Third Principal Meridian, Logan County, Illinois, said circle having a radius of 250.00 feet and a circumference of 1570.80 feet with the center of said circle being more particularly described as follows:

Commencing at the Northeast Corner of said Southeast Quarter, thence south 10.00 feet along the East Line of said Southeast Quarter; thence south 88°-03'-10" west (Bearings derived from Global Positioning – Illinois State Plane Coordinates – West Zone) 2644.21 feet; thence south 01°-39'-03" east 529.56 feet; thence north 88°-12'-10" east 278.51 feet to the center of said circle.

Wind Turbine No. B-35-4-2

A strip of land 3 feet wide being a part of the Southeast Quarter of Section 35, Township 22 North, Range 3 West of the Third Principal Meridian, Logan County, Illinois and lying 1.5 feet on each side of the following described Centerline:

Commencing at the Northeast Corner of said Southeast Quarter, thence south 10.00 feet along the East Line of said Southeast Quarter; thence south 88°-03'-10" west (Bearings derived from Global Positioning – Illinois State Plane Coordinates – West Zone) 987.12 feet to the Point of Beginning; From said Point of Beginning, thence south 01°-40'-07" east 532.13 feet to the Point of Terminus.

ALSO:

All that part of a circle lying in the Southeast Quarter of Section 35, Township 22 North, Range 3 West of the Third Principal Meridian, Logan County, Illinois, said circle having a radius of 250.00 feet and a circumference of 1570.80 feet with the center of said circle being more particularly described as follows:

Commencing at the Northeast Corner of said Southeast Quarter, thence south 10.00 feet along the East Line of said Southeast Quarter; thence south 88°-03'-10" west (Bearings derived from Global Positioning – Illinois State Plane Coordinates – West Zone) 987.12 feet; thence south 01°-40'-07" east 532.13 feet to the center of said circle.

Wind Turbine No. B-36-1-2

A strip of land 3 feet wide being a part of the Northwest Quarter of Section 36, Township 22 North, Range 3 West of the Third Principal Meridian, Logan County, Illinois and lying 1.5 feet on each side of the following described Centerline:

Commencing at the Northwest Corner of said Northwest Quarter, thence easterly 1330.06 feet along the North Line of said Northwest Quarter to the Point of Beginning; From said Point of Beginning, thence south 01°-35'-49" east (Bearings derived from Global Positioning – Illinois State Plane Coordinates – West Zone) 1286.15 feet; thence south 88°-24'-11" west 642.82 feet to the Point of Terminus.

ALSO:

All that part of a circle lying in the Northwest Quarter of Section 36, Township 22 North, Range 3 West of the Third Principal Meridian, Logan County, Illinois, said circle having a radius of 250.00 feet and a circumference of 1570.80 feet with the center of said circle being more particularly described as follows:

Commencing at the Northwest Corner of said Northwest Quarter, thence easterly 1330.06 feet along the North Line of said Northwest Quarter; thence south 01°-35'-49" east (Bearings derived from Global Positioning – Illinois State Plane Coordinates – West Zone) 1286.15 feet; thence south 88°-24'-11" west 642.82 feet to the center of said circle.

Wind Turbine No. B-36-1-3

A strip of land 3 feet wide being a part of the Northwest Quarter of Section 36, Township 22 North, Range 3 West of the Third Principal Meridian, Logan County, Illinois and lying 1.5 feet on each side of the following described Centerline:

Commencing at the Northwest Corner of said Northwest Quarter, thence easterly 1330.06 feet along the North Line of said Northwest Quarter; thence south 01°-35'-49" east (Bearings derived from Global Positioning – Illinois State Plane Coordinates – West Zone) 1248.06 feet to the Point of Beginning; From said Point of Beginning, thence north 88°-19'-01" east 747.47 feet to the Point of Terminus.

ALSO:

All that part of a circle lying in the Northwest Quarter of Section 36, Township 22 North, Range 3 West of the Third Principal Meridian, Logan County, Illinois, said circle having a radius of 250.00 feet and a circumference of 1570.80 feet with the center of said circle being more particularly described as follows:

Commencing at the Northwest Corner of said Northwest Quarter, thence easterly 1330.06 feet along the North Line of said Northwest Quarter; thence south 01°-35'-49" east (Bearings derived from Global Positioning – Illinois State Plane Coordinates – West Zone) 1248.06 feet; thence north 88°-19'-01" east 747.47 feet to the center of said circle.

Wind Turbine No. B-36-2-3

A strip of land 3 feet wide being a part of the East Half of Section 36, Township 22 North, Range 3 West of the Third Principal Meridian, Logan County, Illinois and lying 1.5 feet on each side of the following described Centerline:

Commencing at the Southeast Corner of the Northeast Quarter of said Section 36, thence westerly 552.94 feet along the South Line of said Northeast Quarter to the Point of Beginning; From said Point of Beginning, thence north 01°-41'-31" west (Bearings derived from Global Positioning – Illinois State Plane Coordinates – West Zone) 723.65 feet to the Point of Terminus.

ALSO:

All that part of a circle lying in the East Half of Section 36, Township 22 North, Range 3 West of the Third Principal Meridian, Logan County, Illinois, said circle having a radius of 250.00 feet and a circumference of 1570.80 feet with the center of said circle being more particularly described as follows:

Commencing at the Southeast Corner of the Northeast Quarter of said Section 36, thence westerly 552.94 feet along the South Line of said Northeast Quarter; thence north 01°-41'-31" west (Bearings derived from Global Positioning – Illinois State Plane Coordinates – West Zone) 723.65 feet to the center of said circle.

Wind Turbine No. B-36-3-1

A strip of land 3 feet wide being a part of the Southwest Quarter of Section 36, Township 22 North, Range 3 West of the Third Principal Meridian, Logan County, Illinois and lying 1.5 feet on each side of the following described Centerline:

Commencing at the Northwest Corner of said Southwest Quarter, thence south 517.46 feet along the West Line of said Southwest Quarter to the Point of Beginning; From said Point of Beginning, thence north 88°-20'-24" east (Bearings derived from Global Positioning – Illinois State Plane Coordinates – West Zone) 806.43 feet to the Point of Terminus.

ALSO:

All that part of a circle lying in the Southwest Quarter of Section 36, Township 22 North, Range 3 West of the Third Principal Meridian, Logan County, Illinois, said circle having a radius of 250.00 feet and a circumference of 1570.80 feet with the center of said circle being more particularly described as follows:

Commencing at the Northwest Corner of said Southwest Quarter, thence south 517.46 feet along the West Line of said Southwest Quarter; thence north 88°-20'-24" east (Bearings derived from Global Positioning – Illinois State Plane Coordinates – West Zone) 806.43 feet to the center of said circle.

Wind Turbine No. B-36-4-1

A strip of land 3 feet wide being a part of the East Half of Section 36, Township 22 North, Range 3 West of the Third Principal Meridian, Logan County, Illinois and lying 1.5 feet on each side of the following described Centerline:

Commencing at the Southeast Corner of the Northeast Quarter of said Section 36, thence westerly 1649.53 feet along the South Line of said Northeast Quarter to the Point of Beginning; From said Point of Beginning, thence south 01°-41'-51" east (Bearings derived from Global Positioning – Illinois State Plane Coordinates – West Zone) 569.37 feet to the Point of Terminus.

ALSO:

All that part of a circle lying in the East Half of Section 36, Township 22 North, Range 3 West of the Third Principal Meridian, Logan County, Illinois, said circle having a radius of 250.00 feet and a circumference of 1570.80 feet with the center of said circle being more particularly described as follows:

Commencing at the Southeast Corner of the Northeast Quarter of said Section 36, thence westerly 1649.53 feet along the South Line of said Northeast Quarter; thence south 01°-41'-51" east (Bearings derived from Global Positioning – Illinois State Plane Coordinates – West Zone) 569.37 feet to the center of said circle.

Wind Turbine No. B-36-4-2

A strip of land 3 feet wide being a part of the East Half of Section 36, Township 22 North, Range 3 West of the Third Principal Meridian, Logan County, Illinois and lying 1.5 feet on each side of the following described Centerline:

Commencing at the Southeast Corner of the Northeast Quarter of said Section 36, thence westerly 513.43 feet along the South Line of said Northeast Quarter to the Point of Beginning; From said Point of Beginning, thence south $01^{\circ}-41'-51''$ east (Bearings derived from Global Positioning – Illinois State Plane Coordinates – West Zone) 528.38 feet to the Point of Terminus.

ALSO:

All that part of a circle lying in the East Half of Section 36, Township 22 North, Range 3 West of the Third Principal Meridian, Logan County, Illinois, said circle having a radius of 250.00 feet and a circumference of 1570.80 feet with the center of said circle being more particularly described as follows:

Commencing at the Southeast Corner of the Northeast Quarter of said Section 36, thence westerly 513.43 feet along the South Line of said Northeast Quarter; thence south $01^{\circ}-41'-51''$ east (Bearings derived from Global Positioning – Illinois State Plane Coordinates – West Zone) 528.38 feet to the center of said circle.

Wind Turbine No. E-06-3-1

A strip of land 3 feet wide being a part of the Northeast Quarter of Section 12, Township 21 North, Range 3 West of the Third Principal Meridian and part of the Northwest Quarter of Section 7, Township 21 North, Range 2 West of the Third Principal Meridian and part of the Southwest Quarter of Section 6, Township 21 North, Range 2 West of the Third Principal Meridian, all in Logan County, Illinois and lying 1.5 feet on each side of the following described Centerline:

Beginning at the Northwest Corner of the East Half of the Northeast Quarter of said Section 12; thence south $03^{\circ}-50'-52''$ east (Bearings derived from Global Positioning – Illinois State Plane Coordinates – West Zone) 10.00 feet; thence north $86^{\circ}-09'-08''$ east 996.86 feet; thence south $69^{\circ}-45'-21''$ east 210.75 feet; thence north $88^{\circ}-43'-04''$ east 2181.27 feet; thence north $01^{\circ}-37'-05''$ west 452.46 feet to the Point of Terminus.

ALSO:

All that part of a circle lying in the Southwest Quarter of Section 6, Township 21 North, Range 2 West of the Third Principal Meridian, Logan County, Illinois, said circle having a radius of 250.00 feet and a circumference of 1570.80 feet with the center of said circle being more particularly described as follows:

Commencing at the Northwest Corner of the East Half of the Northeast Quarter of said Section 12; thence south $03^{\circ}-50'-52''$ east (Bearings derived from Global Positioning – Illinois State Plane Coordinates – West Zone) 10.00 feet; thence north $86^{\circ}-09'-08''$ east 996.86 feet; thence south $69^{\circ}-45'-21''$ east 210.75 feet; thence north $88^{\circ}-43'-04''$ east 2181.27 feet; thence north $01^{\circ}-37'-05''$ west 452.46 feet to the center of said circle.

Wind Turbine No. E-07-1-1

A strip of land 3 feet wide being a part of the Northwest Quarter of Section 7, Township 21 North, Range 2 West of the Third Principal Meridian, Logan County, Illinois and lying 1.5 feet on each side of the following described Centerline:

Commencing at the Northwest Corner of the East Half of the Northeast Quarter of Section 12, Township 21 North, Range 3 West of the Third Principal Meridian, Logan County, Illinois; thence south $03^{\circ}-50'-52''$ east (Bearings derived from Global Positioning – Illinois State Plane Coordinates – West Zone) 10.00 feet; thence north $86^{\circ}-09'-08''$ east 996.86 feet; thence south $69^{\circ}-45'-21''$ east 210.75 feet; thence north $88^{\circ}-43'-04''$ east 1678.30 feet to the Point of Beginning; From said Point of Beginning, thence south $01^{\circ}-27'-16''$ east 433.09 feet to the Point of Terminus.

ALSO:

All that part of a circle lying in the Northwest Quarter of Section 7, Township 21 North, Range 2 West of the Third Principal Meridian, Logan County, Illinois, said circle having a radius of 250.00 feet and a circumference of 1570.80 feet with the center of said circle being more particularly described as follows:

Commencing at the Northwest Corner of the East Half of the Northeast Quarter of said Section 12, thence south $03^{\circ}-50'-52''$ east (Bearings derived from Global Positioning – Illinois State Plane Coordinates – West Zone) 10.00 feet; thence north $86^{\circ}-09'-08''$ east 996.86 feet; thence south $69^{\circ}-45'-21''$ east 210.75 feet; thence north $88^{\circ}-43'-04''$ east 1678.30 feet; thence south $01^{\circ}-27'-16''$ east 433.09 feet to the center of said circle.

Wind Turbine No. O-01-1-1

A strip of land 3 feet wide being a part of the Northwest Quarter of Section 1, Township 21 North, Range 3 West of the Third Principal Meridian, Logan County, Illinois and lying 1.5 feet on each side of the following described Centerline:

Commencing at the Southwest Corner of said Northwest Quarter, thence northerly 984.38 feet along the West Line of said Northwest Quarter to the Point of Beginning; From said Point of Beginning, thence north $85^{\circ}-52'-26''$ east (Bearings derived from Global Positioning – Illinois State Plane Coordinates – West Zone) 549.97 feet to the Point of Terminus.

ALSO:

All that part of a circle lying in the Northwest Quarter of Section 1, Township 21 North, Range 3 West of the Third Principal Meridian, Logan County, Illinois, said circle having a radius of 250.00 feet and a circumference of 1570.80 feet with the center of said circle being more particularly described as follows:

Commencing at the Southwest Corner of said Northwest Quarter, thence northerly 984.38 feet along the West Line of said Northwest Quarter; thence north 85°-52'-26" east (Bearings derived from Global Positioning – Illinois State Plane Coordinates – West Zone) 549.97 feet to the center of said circle.

Wind Turbine No. O-01-1-3

A strip of land 3 feet wide being a part of the Northwest Quarter of Section 1, Township 21 North, Range 3 West of the Third Principal Meridian, Logan County, Illinois and lying 1.5 feet on each side of the following described Centerline:

Commencing at the Northeast Corner of said Northwest Quarter, thence westerly 530.96 feet along the North Line of said Northwest Quarter to the Point of Beginning; From said Point of Beginning, thence south 01°-51'-24" east (Bearings derived from Global Positioning – Illinois State Plane Coordinates – West Zone) 2306.78 feet to the Point of Terminus.

ALSO:

All that part of a circle lying in the Northwest Quarter of Section 1, Township 21 North, Range 3 West of the Third Principal Meridian, Logan County, Illinois, said circle having a radius of 250.00 feet and a circumference of 1570.80 feet with the center of said circle being more particularly described as follows:

Commencing at the Northeast Corner of said Northwest Quarter, thence westerly 530.96 feet along the North Line of said Northwest Quarter; thence south 01°-51'-24" east (Bearings derived from Global Positioning – Illinois State Plane Coordinates – West Zone) 2306.78 feet to the center of said circle.

Wind Turbine No. O-01-2-1

A strip of land 3 feet wide being a part of the Northeast Quarter of Section 1, Township 21 North, Range 3 West of the Third Principal Meridian, Logan County, Illinois and lying 1.5 feet on each side of the following described Centerline:

Commencing at the Northwest Corner of the East Half of said Northeast Quarter, thence southerly 2223.24 feet along the West Line of the East Half of said Northeast Quarter to the Point of Beginning; From said Point of Beginning, thence north 85°-52'-26" east (Bearings derived from Global Positioning – Illinois State Plane Coordinates – West Zone) 680.72 feet to the Point of Terminus.

ALSO:

All that part of a circle lying in the Northeast Quarter of Section 1, Township 21 North, Range 3 West of the Third Principal Meridian, Logan County, Illinois, said circle having a radius of 250.00 feet and a circumference of 1570.80 feet with the center of said circle being more particularly described as follows:

Commencing at the Northwest Corner of the East Half of said Northeast Quarter, thence southerly 2223.24 feet along the West Line of the East Half of said Northeast Quarter; thence north 85°-52'-26" east (Bearings derived from Global Positioning – Illinois State Plane Coordinates – West Zone) 680.72 feet to the center of said circle.

Wind Turbine No. O-01-3-1

A strip of land 3 feet wide being a part of the Southwest Quarter of Section 1, Township 21 North, Range 3 West of the Third Principal Meridian, Logan County, Illinois and lying 1.5 feet on each side of the following described Centerline:

Commencing at the Southwest Corner of said Southwest Quarter, thence northerly 1176.56 feet along the West Line of said Southwest Quarter to the Point of Beginning; From said Point of Beginning, thence north 88°-11'-31" east (Bearings derived from Global Positioning – Illinois State Plane Coordinates – West Zone) 1030.23 feet to the Point of Terminus.

ALSO:

All that part of a circle lying in the Southwest Quarter of Section 1, Township 21 North, Range 3 West of the Third Principal Meridian, Logan County, Illinois, said circle having a radius of 250.00 feet and a circumference of 1570.80 feet with the center of said circle being more particularly described as follows:

Commencing at the Southwest Corner of said Southwest Quarter, thence northerly 1176.56 feet along the West Line of said Southwest Quarter; thence north 88°-11'-31" east (Bearings derived from Global Positioning – Illinois State Plane Coordinates – West Zone) 1030.23 feet to the center of said circle.

Wind Turbine No. O-01-4-1

A strip of land 3 feet wide being a part of the Southeast Quarter of Section 1, Township 21 North, Range 3 West of the Third Principal Meridian, Logan County, Illinois and lying 1.5 feet on each side of the following described Centerline:

Commencing at the Southwest Corner of the East Half of said Southeast Quarter, thence northerly 1408.72 feet along the West Line of said East Half to the Point of Beginning; From said Point of Beginning, thence south 85°-52'-26" west (Bearings derived from Global Positioning – Illinois State Plane Coordinates – West Zone) 537.55 feet to the Point of Terminus.

ALSO:

All that part of a circle lying in the Southeast Quarter of Section 1, Township 21 North, Range 3 West of the Third Principal Meridian, Logan County, Illinois, said circle having a radius of 250.00 feet and a circumference of 1570.80 feet with the center of said circle being more particularly described as follows:

Commencing at the Southwest Corner of the East Half of said Southeast Quarter, thence northerly 1408.72 feet along the West Line of said East Half; thence south 85°-52'-26" west (Bearings derived from Global Positioning – Illinois State Plane Coordinates – West Zone) 537.55 feet to the center of said circle.

Wind Turbine No. O-01-4-2

A strip of land 3 feet wide being a part of the Southeast Quarter of Section 1, Township 21 North, Range 3 West of the Third Principal Meridian, Logan County, Illinois and lying 1.5 feet on each side of the following described Centerline:

Commencing at the Southwest Corner of the East Half of said Southeast Quarter, thence northerly 2008.74 feet along the West Line of said East Half to the Point of Beginning; From said Point of Beginning, thence north 85°-52'-26" east (Bearings derived from Global Positioning – Illinois State Plane Coordinates – West Zone) 549.50 feet to the Point of Terminus.

ALSO:

All that part of a circle lying in the Southeast Quarter of Section 1, Township 21 North, Range 3 West of the Third Principal Meridian, Logan County, Illinois, said circle having a radius of 250.00 feet and a circumference of 1570.80 feet with the center of said circle being more particularly described as follows:

Commencing at the Southwest Corner of the East Half of said Southeast Quarter, thence northerly 2008.74 feet along the West Line of said East Half; thence north 85°-52'-26" east (Bearings derived from Global Positioning – Illinois State Plane Coordinates – West Zone) 549.50 feet to the center of said circle.

Wind Turbine No. O-02-1-1

A strip of land 3 feet wide being a part of the North Half of Section 2, Township 21 North, Range 3 West of the Third Principal Meridian, Logan County, Illinois and lying 1.5 feet on each side of the following described Centerline:

Commencing at the Northwest Corner of the Northeast Quarter of said Section 2, thence easterly 1288.69 feet along the North Line of said Northeast Quarter; thence south 02°-14'-21" east (Bearings derived from Global Positioning – Illinois State Plane Coordinates – West Zone) 1117.01 feet; thence south 00°-50'-09" west 265.09 feet; thence south 02°-02'-55" east 563.88 feet; thence south 02°-14'-04" east 923.39 feet; thence south 88°-54'-50" west 1453.92 feet to the Point of Beginning; From said Point of Beginning, thence north 01°-21'-42" west 457.81 feet to the Point of Terminus.

ALSO:

All that part of a circle lying in the Northwest Quarter of Section 2, Township 21 North, Range 3 West of the Third Principal Meridian, Logan County, Illinois, said circle having a radius of 250.00 feet and a circumference of 1570.80 feet with the center of said circle being more particularly described as follows:

Commencing at the Northwest Corner of the Northeast Quarter of said Section 2, thence easterly 1288.69 feet along the North Line of said Northeast Quarter; thence south 02°-14'-21" east (Bearings derived from Global Positioning – Illinois State Plane Coordinates – West Zone) 1117.01 feet; thence south 00°-50'-09" west 265.09 feet; thence south 02°-02'-55" east 563.88 feet; thence south 02°-14'-04" east 923.39 feet; thence south 88°-54'-50" west 1453.92 feet; thence north 01°-21'-42" west 457.81 feet to the center of said circle.

Wind Turbine No. O-02-2-1

A strip of land 3 feet wide being a part of the Northeast Quarter of Section 2, Township 21 North, Range 3 West of the Third Principal Meridian, Logan County, Illinois and lying 1.5 feet on each side of the following described Centerline:

Commencing at the Northwest Corner of the Northeast Quarter of said Section 2, thence easterly 1288.69 feet along the North Line of said Northeast Quarter; thence south 02°-14'-21" east (Bearings derived from Global Positioning – Illinois State Plane Coordinates – West Zone) 1117.01 feet; thence south 00°-50'-09" west 265.09 feet; thence south 02°-02'-55" east 563.88 feet to the Point of Beginning; From said Point of Beginning, thence south 88°-54'-50" west 504.63 feet to the Point of Terminus.

ALSO:

All that part of a circle lying in the Northeast Quarter of Section 2, Township 21 North, Range 3 West of the Third Principal Meridian, Logan County, Illinois, said circle having

a radius of 250.00 feet and a circumference of 1570.80 feet with the center of said circle being more particularly described as follows:

Commencing at the Northwest Corner of the Northeast Quarter of said Section 2, thence easterly 1288.69 feet along the North Line of said Northeast Quarter; thence south $02^{\circ}-14'-21''$ east (Bearings derived from Global Positioning – Illinois State Plane Coordinates – West Zone) 1117.01 feet; thence south $00^{\circ}-50'-09''$ west 265.09 feet; thence south $02^{\circ}-02'-55''$ east 563.88 feet; thence south $88^{\circ}-54'-50''$ west 504.63 feet to the center of said circle.

Wind Turbine No. O-02-3-1

A strip of land 3 feet wide being a part of Section 2, Township 21 North, Range 3 West of the Third Principal Meridian, Logan County, Illinois and lying 1.5 feet on each side of the following described Centerline:

Commencing at the Northwest Corner of the Northeast Quarter of said Section 2, thence easterly 1288.69 feet along the North Line of said Northeast Quarter to the Point of Beginning; From said Point of Beginning, thence south $02^{\circ}-14'-21''$ east (Bearings derived from Global Positioning – Illinois State Plane Coordinates – West Zone) 1117.01 feet; thence south $00^{\circ}-50'-09''$ west 265.09 feet; thence south $02^{\circ}-02'-55''$ east 563.88 feet; thence south $02^{\circ}-14'-04''$ east 923.39 feet; thence south $88^{\circ}-54'-50''$ west 2327.21 feet; thence south $01^{\circ}-44'-27''$ east 172.84 feet to the Point of Terminus.

ALSO:

All that part of a circle lying in the Southwest Quarter of Section 2, Township 21 North, Range 3 West of the Third Principal Meridian, Logan County, Illinois, said circle having a radius of 250.00 feet and a circumference of 1570.80 feet with the center of said circle being more particularly described as follows:

Commencing at the Northwest Corner of the Northeast Quarter of said Section 2, thence easterly 1288.69 feet along the North Line of said Northeast Quarter; thence south $02^{\circ}-14'-21''$ east (Bearings derived from Global Positioning – Illinois State Plane Coordinates – West Zone) 1117.01 feet; thence south $00^{\circ}-50'-09''$ west 265.09 feet; thence south $02^{\circ}-02'-55''$ east 563.88 feet; thence south $02^{\circ}-14'-04''$ east 923.39 feet; thence south $88^{\circ}-54'-50''$ west 2327.21 feet; thence south $01^{\circ}-44'-27''$ east 172.84 feet to the center of said circle.

Wind Turbine No. O-03-2-1

A strip of land 3 feet wide being a part of the Northeast Quarter of Section 3, Township 21 North, Range 3 West of the Third Principal Meridian, Logan County, Illinois and lying 1.5 feet on each side of the following described Centerline:

Commencing at the Northeast Corner of the Northeast Quarter of said Section 3, thence westerly 697.51 feet along the North Line of said Northeast Quarter to the Point of Beginning; From said Point of Beginning, thence south $01^{\circ}-21'-42''$ east (Bearings derived from Global Positioning – Illinois State Plane Coordinates – West Zone) 1233.52 feet to the Point of Terminus.

ALSO:

All that part of a circle lying in the Northeast Quarter of Section 3, Township 21 North, Range 3 West of the Third Principal Meridian, Logan County, Illinois, said circle having a radius of 250.00 feet and a circumference of 1570.80 feet with the center of said circle being more particularly described as follows:

Commencing at the Northeast Corner of the Northeast Quarter of said Section 3, thence westerly 697.51 feet along the North Line of said Northeast Quarter; thence south $01^{\circ}-21'-42''$ east (Bearings derived from Global Positioning – Illinois State Plane Coordinates – West Zone) 1233.52 feet to the center of said circle.

Wind Turbine No. O-03-3-1

A strip of land 3 feet wide being a part of the Southwest Quarter of Section 3, Township 21 North, Range 3 West of the Third Principal Meridian, Logan County, Illinois and lying 1.5 feet on each side of the following described Centerline:

Commencing at the Southeast Corner of said Southwest Quarter, thence westerly 984.22 feet along the South Line of said Southeast Quarter to the Point of Beginning; From said Point of Beginning, thence north $01^{\circ}-34'-12''$ west (Bearings derived from Global Positioning – Illinois State Plane Coordinates – West Zone) 534.74 feet to the Point of Terminus.

ALSO:

All that part of a circle lying in the Southwest Quarter of Section 3, Township 21 North, Range 3 West of the Third Principal Meridian, Logan County, Illinois, said circle having a radius of 250.00 feet and a circumference of 1570.80 feet with the center of said circle being more particularly described as follows:

Commencing at the Southeast Corner of said Southwest Quarter, thence westerly 984.22 feet along the South Line of said Southeast Quarter; thence north $01^{\circ}-34'-12''$ west (Bearings derived from Global Positioning – Illinois State Plane Coordinates – West Zone) 534.74 feet to the center of said circle.

Wind Turbine No. O-03-3-2

A strip of land 3 feet wide being a part of the Southwest Quarter of Section 3, Township 21 North, Range 3 West of the Third Principal Meridian, Logan County, Illinois and lying 1.5 feet on each side of the following described Centerline:

Commencing at the Southeast Corner of said Southwest Quarter, thence westerly 27.45 feet along the South Line of said Southeast Quarter to the Point of Beginning; From said Point of Beginning, thence north $01^{\circ}-14'-31''$ west (Bearings derived from Global Positioning – Illinois State Plane Coordinates – West Zone) 1524.51 feet; thence south $88^{\circ}-29'-55''$ west 491.47 feet to the Point of Terminus.

ALSO:

All that part of a circle lying in the Southwest Quarter of Section 3, Township 21 North, Range 3 West of the Third Principal Meridian, Logan County, Illinois, said circle having a radius of 250.00 feet and a circumference of 1570.80 feet with the center of said circle being more particularly described as follows:

Commencing at the Southeast Corner of said Southwest Quarter, thence westerly 27.45 feet along the South Line of said Southeast Quarter; thence north $01^{\circ}-14'-31''$ west (Bearings derived from Global Positioning – Illinois State Plane Coordinates – West Zone) 1524.51 feet; thence south $88^{\circ}-29'-55''$ west 491.47 feet to the center of said circle.

Wind Turbine No. O-03-4-1

A strip of land 3 feet wide being a part of the Southeast Quarter of Section 3 and part of the Southwest Quarter of Section 2, both in Township 21 North, Range 3 West of the Third Principal Meridian, Logan County, Illinois and lying 1.5 feet on each side of the following described Centerline:

Commencing at the Southwest Corner of the Southwest Quarter of said Section 2, thence easterly 76.82 feet along the South Line of said Southwest Quarter to the Point of Beginning; From said Point of Beginning, thence north $31^{\circ}-38'-18''$ west (Bearings derived from Global Positioning – Illinois State Plane Coordinates – West Zone) 102.78 feet; thence north $01^{\circ}-21'-42''$ west 1272.12 feet; thence south $88^{\circ}-47'-53''$ west 800.14 feet; thence north $01^{\circ}-12'-07''$ west 611.09 feet to the Point of Terminus.

ALSO:

All that part of a circle lying in the Southeast Quarter of Section 3, Township 21 North, Range 3 West of the Third Principal Meridian, Logan County, Illinois, said circle having a radius of 250.00 feet and a circumference of 1570.80 feet with the center of said circle being more particularly described as follows:

Commencing at the Southwest Corner of the Southwest Quarter of said Section 2, thence easterly 76.82 feet along the South Line of said Southwest Quarter; thence north $31^{\circ}-38'-18''$ west (Bearings derived from Global Positioning – Illinois State Plane Coordinates – West Zone) 102.78 feet; thence north $01^{\circ}-21'-42''$ west 1272.12 feet; thence south $88^{\circ}-47'-53''$ west 800.14 feet; thence north $01^{\circ}-12'-07''$ west 611.09 feet to the center of said circle.

Wind Turbine No. O-10-1-1

A strip of land 3 feet wide being a part of the Northwest Quarter of Section 10, Township 21 North, Range 3 West of the Third Principal Meridian, Logan County, Illinois and lying 1.5 feet on each side of the following described Centerline:

Commencing at the Northeast Corner of said Northwest Quarter, thence westerly 28.43 feet along the North Line of said Northwest Quarter to the Point of Beginning; From said Point of Beginning, thence south $01^{\circ}-08'-10''$ east (Bearings derived from Global Positioning – Illinois State Plane Coordinates – West Zone) 1507.72 feet; thence south $88^{\circ}-54'-23''$ west 1259.24 feet to the Point of Terminus.

ALSO:

All that part of a circle lying in the Northwest Quarter of Section 10, Township 21 North, Range 3 West of the Third Principal Meridian, Logan County, Illinois, said circle having a radius of 250.00 feet and a circumference of 1570.80 feet with the center of said circle being more particularly described as follows:

Commencing at the Northeast Corner of said Northwest Quarter, thence westerly 28.43 feet along the North Line of said Northwest; thence south $01^{\circ}-08'-10''$ east (Bearings derived from Global Positioning – Illinois State Plane Coordinates – West Zone) 1507.72 feet; thence south $88^{\circ}-54'-23''$ west 1259.24 feet to the center of said circle.

Wind Turbine No. O-10-1-2

A strip of land 3 feet wide being a part of the Northwest Quarter of Section 10, Township 21 North, Range 3 West of the Third Principal Meridian, Logan County, Illinois and lying 1.5 feet on each side of the following described Centerline:

Commencing at the Northeast Corner of said Northwest Quarter, thence westerly 28.43 feet along the North Line of said Northwest Quarter; thence south $01^{\circ}-08'-10''$ east (Bearings derived from Global Positioning – Illinois State Plane Coordinates – West Zone) 801.86 feet to the Point of Beginning; From said Point of Beginning, thence south $88^{\circ}-30'-07''$ west 411.15 feet to the Point of Terminus.

ALSO:

All that part of a circle lying in the Northwest Quarter of Section 10, Township 21 North, Range 3 West of the Third Principal Meridian, Logan County, Illinois, said circle having a radius of 250.00 feet and a circumference of 1570.80 feet with the center of said circle being more particularly described as follows:

Commencing at the Northeast Corner of said Northwest Quarter, thence westerly 28.43 feet along the North Line of said Northwest Quarter; thence south $01^{\circ}-08'-10''$ east (Bearings derived from Global Positioning – Illinois State Plane Coordinates – West Zone) 801.86 feet; thence south $88^{\circ}-30'-07''$ west 411.15 feet to the center of said circle.

Wind Turbine No. O-10-2-1

A strip of land 3 feet wide being a part of the Northeast Quarter of Section 10, Township 21 North, Range 3 West of the Third Principal Meridian, Logan County, Illinois and lying 1.5 feet on each side of the following described Centerline:

Commencing at the Northwest Corner of said Northeast Quarter, thence easterly 710.04 feet along the North Line of said Northeast Quarter to the Point of Beginning; From said Point of Beginning, thence south $01^{\circ}-13'-53''$ east (Bearings derived from Global Positioning – Illinois State Plane Coordinates – West Zone) 586.84 feet to the Point of Terminus.

ALSO:

All that part of a circle lying in the Northeast Quarter of Section 10, Township 21 North, Range 3 West of the Third Principal Meridian, Logan County, Illinois, said circle having a radius of 250.00 feet and a circumference of 1570.80 feet with the center of said circle being more particularly described as follows:

Commencing at the Northwest Corner of said Northeast Quarter, thence easterly 710.04 feet along the North Line of said Northeast Quarter; thence south $01^{\circ}-13'-53''$ east (Bearings derived from Global Positioning – Illinois State Plane Coordinates – West Zone) 586.84 feet to the center of said circle.

Wind Turbine No. O-11-1-1

A strip of land 3 feet wide being a part of the Northwest Quarter of Section 11, Township 21 North, Range 3 West of the Third Principal Meridian, Logan County, Illinois and lying 1.5 feet on each side of the following described Centerline:

Commencing at the Northeast Corner of said Northwest Quarter, thence westerly 1326.24 feet along the North Line of said Northwest Quarter to the Point of Beginning; From said Point of Beginning, thence south $01^{\circ}-28'-35''$ east (Bearings derived from Global Positioning – Illinois State Plane Coordinates – West Zone) 584.81 feet; thence

south 06°-15'-56" west 74.23 feet; thence south 01°-28'-35" east 544.08 feet; thence south 88°-59'-28" west 164.82 feet to the Point of Terminus.

ALSO:

All that part of a circle lying in the Northwest Quarter of Section 11, Township 21 North, Range 3 West of the Third Principal Meridian, Logan County, Illinois, said circle having a radius of 250.00 feet and a circumference of 1570.80 feet with the center of said circle being more particularly described as follows:

Commencing at the Northeast Corner of said Northwest Quarter, thence westerly 1326.24 feet along the North Line of said Northwest Quarter; thence south 01°-28'-35" east (Bearings derived from Global Positioning – Illinois State Plane Coordinates – West Zone) 584.81 feet; thence south 06°-15'-56" west 74.23 feet; thence south 01°-28'-35" east 544.08 feet; thence south 88°-59'-28" west 164.82 feet to the center of said circle.

Wind Turbine No. O-11-1-2

A strip of land 3 feet wide being a part of the Northwest Quarter of Section 11, Township 21 North, Range 3 West of the Third Principal Meridian, Logan County, Illinois and lying 1.5 feet on each side of the following described Centerline:

Commencing at the Northeast Corner of said Northwest Quarter, thence westerly 1326.24 feet along the North Line of said Northwest Quarter; thence south 01°-28'-35" east (Bearings derived from Global Positioning – Illinois State Plane Coordinates – West Zone) 584.81 feet to the Point of Beginning; From said Point of Beginning, thence south 01°-28'-35" east 46.70 feet; thence south 28°-55'-50" east 174.12 feet; thence north 89°-20'-31" east 697.37 feet to the Point of Terminus.

ALSO:

All that part of a circle lying in the Northwest Quarter of Section 11, Township 21 North, Range 3 West of the Third Principal Meridian, Logan County, Illinois, said circle having a radius of 250.00 feet and a circumference of 1570.80 feet with the center of said circle being more particularly described as follows:

Commencing at the Northeast Corner of said Northwest Quarter, thence westerly 1326.24 feet along the North Line of said Northwest Quarter; thence south 01°-28'-35" east (Bearings derived from Global Positioning – Illinois State Plane Coordinates – West Zone) 584.81; thence south 01°-28'-35" east 46.70 feet; thence south 28°-55'-50" east 174.12 feet; thence north 89°-20'-31" east 697.37 feet to the center of said circle.

Wind Turbine No. O-11-2-1

A strip of land 3 feet wide being a part of the Northeast Quarter of Section 11, Township 21 North, Range 3 West of the Third Principal Meridian, Logan County, Illinois and lying 1.5 feet on each side of the following described Centerline:

Beginning at the Northwest Corner of said Northeast Quarter, From said Point of Beginning, thence south $01^{\circ}-30'-44''$ east 1758.28 feet along the West Line of said Northeast Quarter; thence north $88^{\circ}-29'-16''$ east (Bearings derived from Global Positioning – Illinois State Plane Coordinates – West Zone) 519.40 feet to the Point of Terminus.

ALSO:

All that part of a circle lying in the Northeast Quarter of Section 11, Township 21 North, Range 3 West of the Third Principal Meridian, Logan County, Illinois, said circle having a radius of 250.00 feet and a circumference of 1570.80 feet with the center of said circle being more particularly described as follows:

Commencing at the Northwest Corner of said Northeast Quarter, thence south $01^{\circ}-30'-44''$ east 1758.28 feet along the West Line of said Northeast Quarter; thence north $88^{\circ}-29'-16''$ east (Bearings derived from Global Positioning – Illinois State Plane Coordinates – West Zone) 519.40 feet to the center of said circle.

EXHIBIT B
Map of the Amended Territory

929

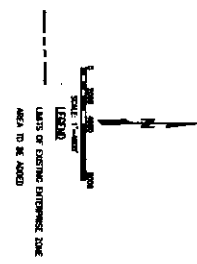
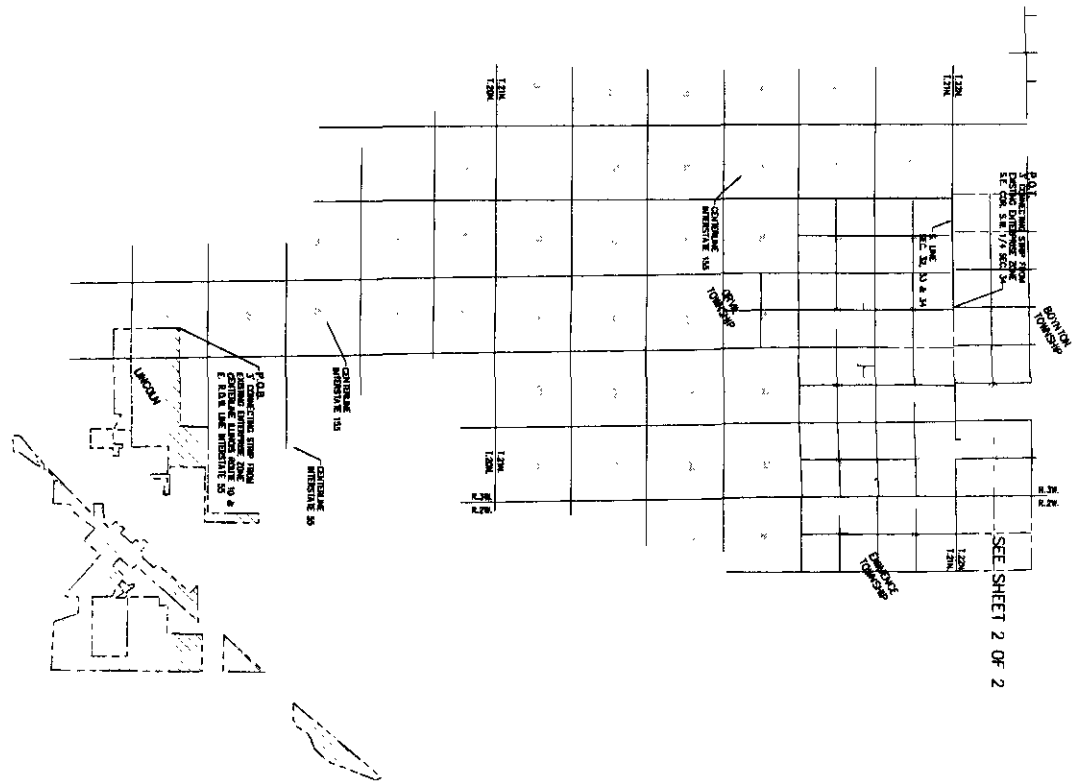

| | | | |
|---|----------------|--|---------------------|
| | | ENTERPRISE ZONE | |
| 200 Macomber Road Suite 1120 1000 West 12th Street Lincoln, NE 68502 | | PAUL SHUTTER WIND FARM, LLC LINCOLN COUNTY, KANSAS | |
| Date: 12/17/23 9:45 AM Drawn: J. Johnson Checked: J. Johnson | Scale: 1"=400' | Sheet No.: 1 of 2 | Project No.: 24-001 |

1:25000 Scale

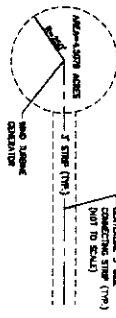
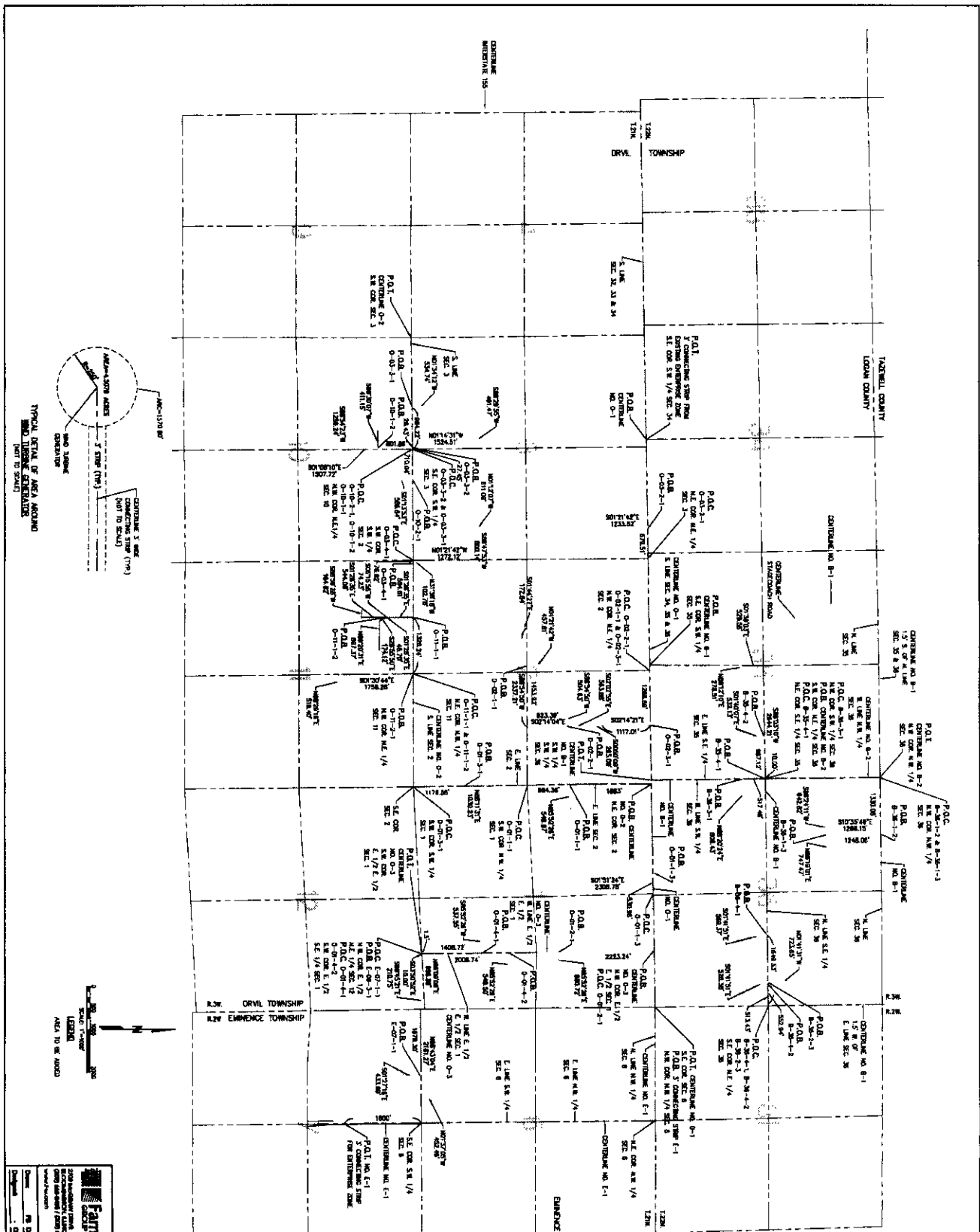

Fairsworth
 CONSULTING ENGINEERS
 1000 WEST 10TH AVENUE
 DENVER, CO 80202
 PHONE: 303.733.8888
 FAX: 303.733.8889
 WWW: www.fairsworth.com

ENTERPRISE ZONE
 PAUL GRUTTEN WARD PARTIAL LTD
 LOGAN COUNTY, KANSAS
 Project No. 2 OF 2
 Printed On: 08/20/14 File No: 94-0071

EXHIBIT C
Amendment to Enterprise Zone Intergovernmental Agreement
Between the Logan County, City of Lincoln, Sangamon County and Village of Elkhart

AMENDMENT TO THAT CERTAIN 1986, 1987 ENTERPRISE ZONE INTERGOVERNMENTAL AGREEMENT BETWEEN LOGAN COUNTY, THE CITY OF LINCOLN, SANGAMON COUNTY AND THE VILLAGE OF ELKHART

THIS AMENDMENT TO ENTERPRISE ZONE INTERGOVERNMENTAL AGREEMENT (this "Amendment") is entered into as of this ____ day of _____, 2008 by and between the County of Logan, Illinois ("Logan"), the City of Lincoln, Illinois ("Lincoln"), the Village of Elkhart, Illinois ("Elkhart") and the County of Sangamon, Illinois ("Sangamon" and together with Logan, Lincoln and Elkhart, the "Parties").

WITNESSETH:

WHEREAS, Logan, Lincoln, Elkhart, and Sangamon each adopted respective ordinances, as amended, establishing and designating an Enterprise Zone encompassing contiguous portions of Logan, Lincoln, Elkhart, and Sangamon (such zone, as amended, being the "Enterprise Zone");

WHEREAS, Lincoln adopted Ordinance No. 219 on December 23, 1986 and Ordinance No. 222 on February 17, 1987, and Logan adopted Ordinance No. 1986 on December 16, 1986, approving the execution by Lincoln and Logan of the "Enterprise Zone Intergovernmental Agreement" establishing the Enterprise Zone. Such Enterprise Zone Intergovernmental Agreement was amended by that certain "Amendment to the 1986, 1987 Enterprise Zone Intergovernmental Agreement," dated September 21, 2004 in order to, among other things, add the governmental units of Sangamon and Elkhart to the Enterprise Zone (such Enterprise Zone Intergovernmental Agreement and all other amendments, modifications or agreements related thereto, being herein collectively referred to as, the "Intergovernmental Agreement").

WHEREAS, Lincoln and Logan have received a request from Rail Splitter Wind Farm LLC and its affiliates (collectively, "Rail Splitter") for an amendment to the Enterprise Zone in order to include the area of their proposed development within the Enterprise Zone; and

WHEREAS, it would be in the best interests of the citizens of Lincoln, Logan, Sangamon and Elkhart for the aforementioned property to be included in the Enterprise Zone.

NOW, THEREFORE, in consideration of the mutual covenants and promises herein provided, the Parties hereby agree as follows:

SECTION ONE: The Intergovernmental Agreement is hereby amended such that the real property which comprises the Enterprise Zone shall include that certain real property (the "Amended Territory") legally described on Exhibit A attached hereto and made a part hereof (which real property is also depicted on that certain map attached hereto and made a part hereof as Exhibit B); and that the Amended Territory is hereby designated part of the Enterprise Zone pursuant to and in accordance with the Illinois Enterprise Zone Act. (20 ILCS 655/1 et seq.)

SECTION TWO: The Intergovernmental Agreement is hereby further amended to reflect the City of Lincoln Ordinance No. ____ attached hereto and made a part hereof as Exhibit C, Logan County Ordinance No. ____ attached hereto and made a part hereof as Exhibit D, Sangamon County Resolution No. ____ attached hereto and made a part hereof as Exhibit E and the Village of Elkhart Ordinance No. ____ attached hereto and made a part hereof as Exhibit F (collectively, the "Ordinances"). In confirmation and furtherance thereof, in the event of any conflict or inconsistency between the terms and provisions of the Ordinances and the Intergovernmental Agreement (without giving effect to this Amendment), the terms and provisions of the Ordinances shall govern and control and the conflicting and inconsistent terms

and provisions of the Intergovernmental Agreement (without giving effect to this Amendment) shall no longer have any force or effect.

SECTION THREE: Except as otherwise amended or provided in this Amendment, the Intergovernmental Agreement shall remain in full force and effect.

IN WITNESS WHEREOF, on behalf of Lincoln, Logan, Sangamon and Elkhart, the Mayor of the City of Lincoln, the County Board Chairman of Logan County, the County Board Chairman of Sangamon County and the President of the Village of Elkhart respectively, approve, accept and execute this Amendment this 13th day of May, 2008.

CITY OF LINCOLN, ILLINOIS

COUNTY OF LOGAN, ILLINOIS

MAYOR, CITY OF LINCOLN

CHAIRMAN, LOGAN COUNTY

VILLAGE OF ELKHART, ILLINOIS

COUNTY OF SANGAMON, ILLINOIS

PRESIDENT,
VILLAGE OF ELKHART COUNTY

A. V. G. [Signature]

CHAIRMAN, SANGAMON

9-35

EXHIBIT A
Legal Description of the Amended Territory

9-36

EXHIBIT B
Map of the Amended Territory

937

EXHIBIT C
Lincoln Ordinance

938

EXHIBIT D
Logan Ordinance

EXHIBIT E
Sangamon Ordinance

9-40

EXHIBIT F
Elkhart Ordinance